

2419 Westlake Drive Austin, Texas

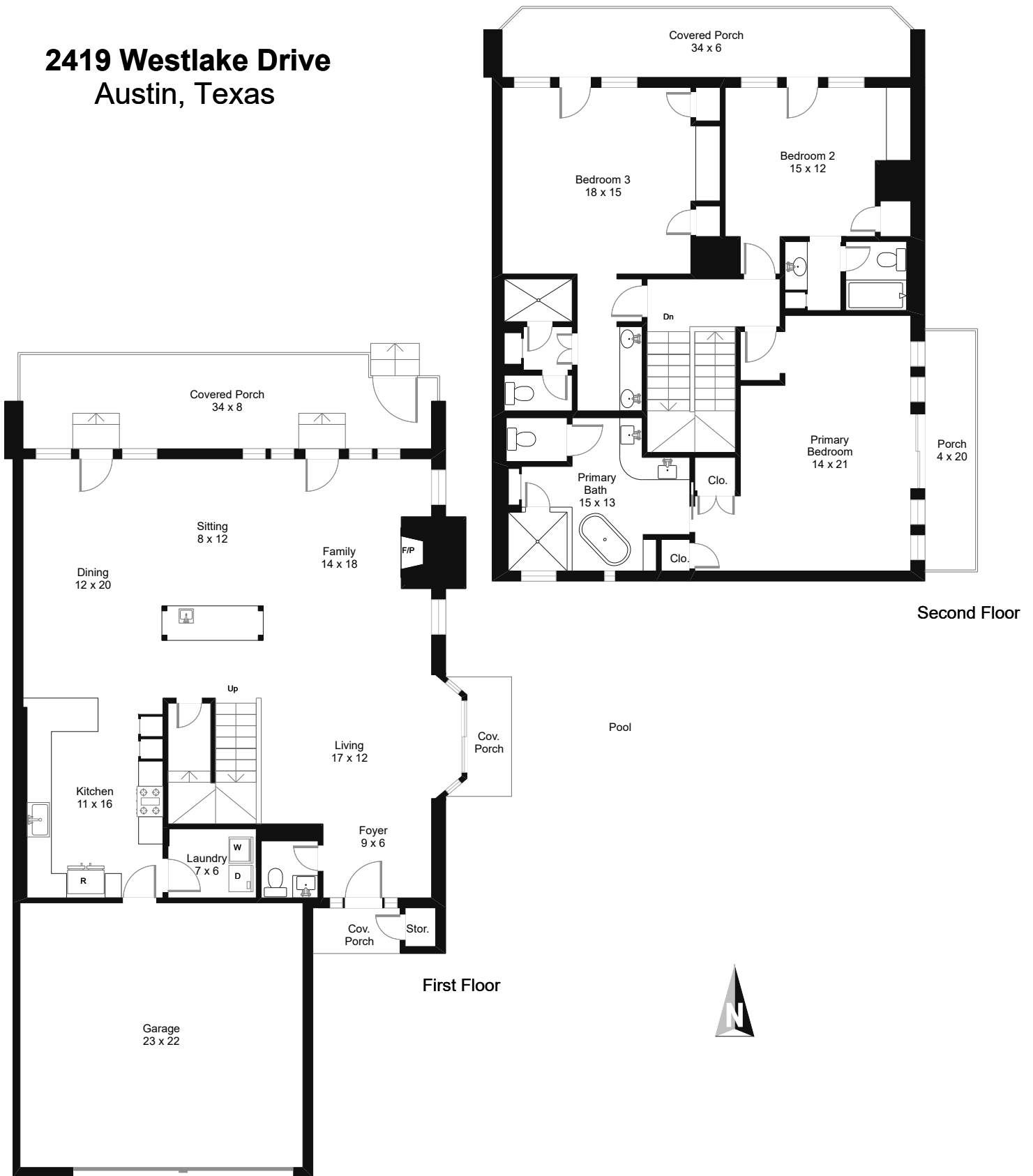

© Floor Plan Graphics LLC 2023. This floor plan is an artistic rendering only. All dimensions are approximate. Floor Plan Graphics LLC and Compass Real Estate make no representation or warranty as to this rendering's accuracy and no measurements or dimensions should be relied upon without independent verification. This floor plan and its respective square footage information and material remain the property of Floor Plan Graphics LLC.



Marketed by Joanie Capalupo, Broker Associate-Compass, 512.470.7467, joanie.capalupo@compass.com
Floor plan by Floor Plan Graphics LLC, 512.454.0383, FloorPlanGraphics.com

FLOOR PLAN
GRAPHICS

December 8, 2023
File #014756.01.02
Joanie Capalupo
joanie.capalupo@compass.com

Via Email:

Subject: Square Footage (SF) calculation for 2419 Westlake Dr, Austin, TX

In my opinion, regarding the above referenced property, the square footages (SF), as calculated from outside corner to outside corner, excluding the common wall, which was assumed to be double framed and therefore was calculated from the center of said wall, are outlined below:

1,348 SF - Condominium, First Floor (Above Grade)
1,474 SF - Condominium, Second Floor (Above Grade)

2,822 SF - Condominium Total

The following are not included in the Condominium Total above:

14 SF - Exterior Storage closet, First Floor (Above Grade)
557 SF - Garage (Above Grade)
27 SF - Attached Front Covered Porch, First Floor
39 SF - Attached Side Covered Porch, First Floor
270 SF - Attached Rear Covered Porch with steps, First Floor
87 SF - Attached Side Porch, Second Floor
194 SF - Attached Rear Covered Porch, Second Floor

Please contact me if you have any questions.

Sincerely,
Alan Birdsong
Floor Plan Graphics LLC

NOTE: This document and its respective floor plans are the property of Floor Plan Graphics and are licensed to the above named person for his or her exclusive use until such time as the listing agreement is terminated or the property has sold. Floor Plan Graphics LLC retains the rights and ownership of all intellectual properties that it produces.